



Quick Installation Guide

Outdoor HD Wireless IP Camera



Model: SABIP1300

V1.0

Package Contents

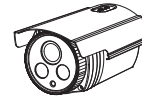

IP Camera



Power Adapter



Ethernet Cable

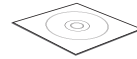

Resource CD



Quick Installation Guide



Mounting Bracket

1 Hardware Introduction

Physical Description

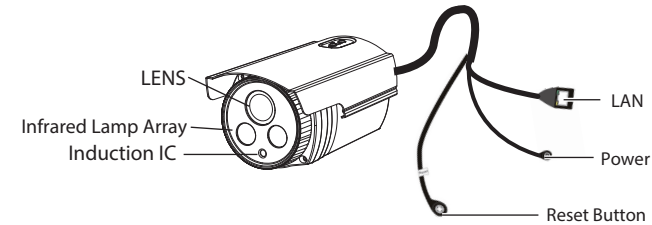

Hardware Installation

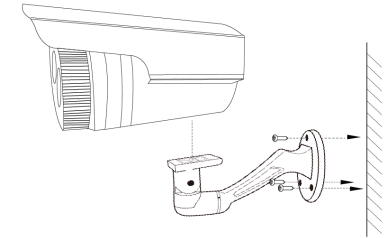

1. Screw the mount on the wall with the 3 screws provided.
2. Install the camera on the mounting bracket with 1 screw to complete installation.

Please Note:

The tail line's wall hole must be lower than socket, ensure that the rain will not allow the device to get wet due to the tail line.

■ Hardware Connection

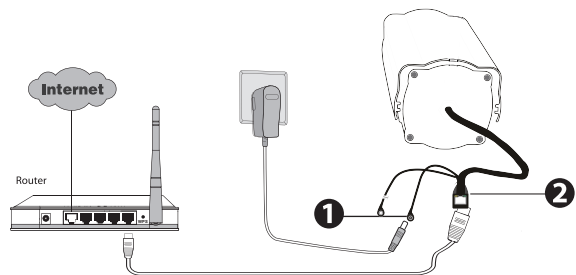

1. Connect the power adapter to the camera.
2. Connect the camera to the wireless router via ethernet cable.

Before you continue, please note:

Make sure your smartphone is connected to the internet.

2 Add the IP Camera

You can add the IP Camera by Smart Phone.

1. Download the App

You can go to the App Store or Google Play store and search for "SAB IPC Viewer". please download and install it.

The App icon will be displayed after successful installation:



SAB IPC Viewer

2. Add the IP Camera

Run the APP, then you can tap the "+" button on the App and follow the wizard to add your camera.

3 Access the IP Camera

After your camera has been successfully added, you can access the IP Camera via the App or computer.

Please Note:

If you want to use your camera in traditional way, you can search and access its local website in LAN(Local Area Network).

Please copy the "Equipment Search Tool" file from the CD to your computer, run it to search and access the IP Camera in LAN.



4 FAQ

Forget Username / Password

Restore camera back to factory settings:

1. Press "Reset" button for about 10 seconds with camera powered on.
2. Release the button and wait about 30 seconds, the camera will automatically restart, and restore factory settings with its username / password recovery to admin / (blank) .

